

VTL-Series

- High rigid of cross roller guide ways enable to have heavy cutting
- Ac servo motor & high accuracy roller ball screw, direct drive, as well as pretension, less of thermal extension, enhance repeatability and positioning accuracy
- High rigid of construction, base close to square design, less vibration
- Easy for auto connection machining
- Friendly design of operation
- High speed/High accuracy /High rigid spindle using NN series bearing, which is able to take axial & radial cutting
- Easy chip removal
- Slant bed-easy for chips flow into the chip conveyor
- Swivel control panel



MACHINE SPECIFICATIONS

ITEM	MODEL	VTL-600
CAPACITY		
Max swing	mm (in)	710 (28)
Max turning diameter	mm (in)	600 (23.6)
Max turning length	mm (in)	500 (19.7)
TRAVEL		
X axis	mm (in)	306 (12.04)
Z axis	mm (in)	505 (19.9)
SPINDLE		
Spindle speeds range	rpm	2000
Chuck size	in	15"
Spindle nose		A2-11
Spindle motor power	kW (HP)	22 (30)
TURRET		
Number of tool stations (live tools)	pcs	8
Shank height for square tool	mm (in)	32 (1.25)
Shank diameter for boring bar	mm (in)	50 (2)
Turret indexing time (adjacent tool)	sec	0.6
Turret indexing time (180 deg)	sec	1.85
FEEDRATE		
X,Z axis rapid traverse	M/min (ipm)	20/24 (788/945)
MOTORS		
X axis motor	kW (HP)	3 (4)
Z axis motor	kW (HP)	4 (5.3)
MACHINE SIZE		
Total machine weight	kg	9000
Machine height	mm (in)	2950 (116.1)
Machine length	mm (in)	2400 (94.5)
Machine width	mm (in)	1800 (70.9)
Power requirements	KVA	-

ITEM	MODEL	VTL-1200	VTL-1600
CAPACITY			
Max. swing diameter	mm	1,600	2,000
Max. turning diameter	mm	1,600	2,000
Distance from bite holder end to table surface	mm	0-205	0-605
Max. turning height	mm	1,200	1,600
Max. workpiece weight	kg	8,000	10,000
SPINDLE			
Table diameter (Manual chuck)	mm	ø250	ø1600
Range of table speed	rpm	1-312	1-256
Change gear speed		2 steps	2 steps
Max of Table torque	N.m	12,400	18,400
ATC			
ATC (Automatic Tool Change)	ea	1set (12 pocket)	1set (12 pocket)
Number of position	mm	12 position/Random	12 position/Random
Tool size		□25 □32 □40	□25 □32 □40
Cross-section of ram	mm	200 x200	240°x240
FEED			
Rapid rate (X-Axis)	m/min	10	10
Rapid rate (Z-Axis)	m/min	10	10
Horizontal travel (X-Axis)	mm	-820+1000(Ref.point)	-1020+1220(Ref.point)
Vertical travel (Z-Axis)	mm	900	900
Cutting feed rate	mm/rev	0.001-50	0.001-50
Feed override	%	0-150	0-150
Cross-rail travel	mm	500 (3 position)	750 (4 position)
MOTORS			
Table main motor(con/30 min.)	kW	AC37/45	AC45/55
Feed servo motor(X/Z axis)	kW	AC7kW/AC7kW	AC7kW/AC7kW
Power requirement	kVA	100kw	120kw
MACHINE SIZE			
Floor space (L x W)	mm	6,230x4,875	6,940x5,500
Max. Height (H)	mm	5,078	5,550
Net. Weight	kg	22,000	28,000

VTL-600 MACHINE DIMENSIONAL

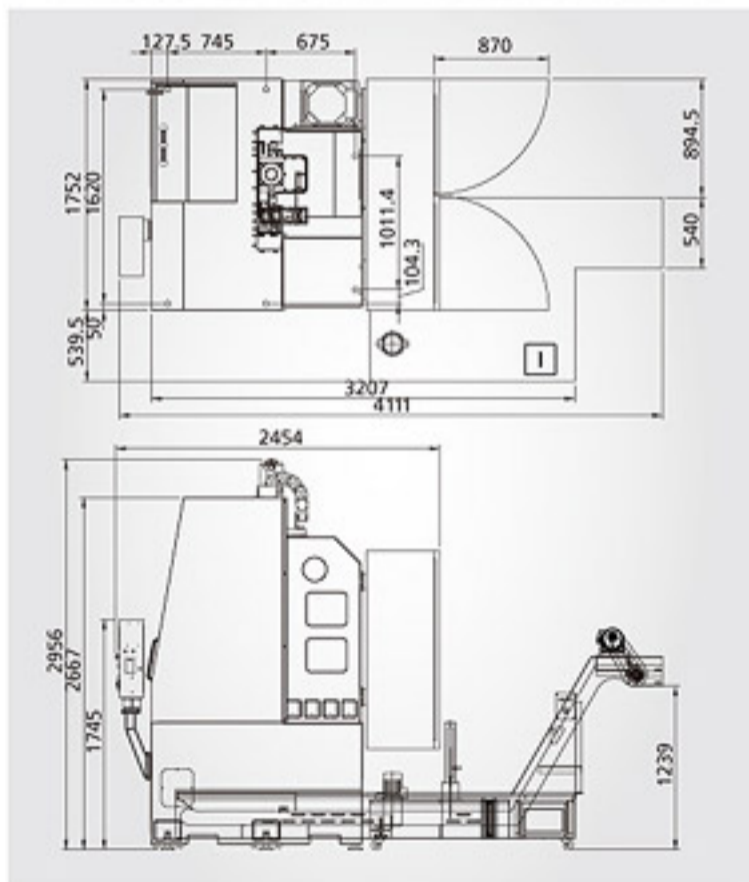

◆ STANDARD ACCESSORIES

- Complete splash guard (and Safety door)
- Hydraulic unit
- Table manual 4-jaw chuck
- Automatic lubrication system
- Work light
- Three color warning light (R/Y/G)
- Workpiece counter(FANUC standard)
- Coolant through tool holder
- Heat exchanger for electrical cabinet
- Table lubrication unit
- Service tool box & tool kits
- Leveling bolts & seat pads
- Chip conveyor
- Chip trolley
- Moveable vertical crossrail and mechanism
- Coolant system with tank (3 Bar)

◆ OPTIONAL ACCESSORIES

- Air conditioner for electrical cabinet
- Transformer for power source 220V, 380V, 440V
- Oil Separator for coolant
- Tool holder (ATC devic)
- Special bite holder
- Tool Measuring device
- Linear scale for X & Z axis (closed loop control system)
- High pressure coolant pump (6 Bar or 10 Bar)
- Conversational screen display language
- Jig & fixer modle design
- CNC Fanuc 18iTC control package.
- APC (2 pallet / 2station)
- APC (2 pallet / 3station)
- Splash guard of auto door
- Oil temperature controller for table lubrication unit
- Oil level readout

LEADWELL CNC MACHINES MFG.,CORP.

NO.23, Gong 33th Road, Taichung Industrial Park Taichung 407, Taiwan
 TEL: 886-4-23591880 FAX: 886-4-23592555, 23593875

E-mail: sales@leadwell.com.tw

www.leadwell.com.tw